

TLS Series

Soft Sound Tactile Switch



Description

TLS is an additional tactile series in a new form factor (8.6 x 8.40 x 3.95 mm) in SMT, with soft actuator and a flat cage for a positive tactile feedback with a soft sound. Its soft actuator & pre-travel help for an easier tolerance management with possible pre-load.

Features & Benefits

- New soft sound
- Soft actuator
- IP54
- Long life
- J terminations
- Tape & reel

Applications

- Automotive interior controls
- Automatic gear shift paddle
- Steering wheel
- Window lifter
- Seat adjustment module

Specifications

Power	10µA min. / 0.8 VA max.
Voltage	DC 1V min. / 16 V max.
Current	10µA min. / 50 VA max.
Operating Temperature	-40°C to 90°C

Process

Packaging	Switches in reels of 900 pieces. Dimensions of reels according to EIA 481B. External diameter 330 mm.
------------------	--

Type	Force (N)	Tactile Feeling (%)	Travel (mm)	Life (cycles)
TLS A 040J LFS	4 ± 0.8	50 ± 15	0.9 ± 0.3	1,000,000
TLS A 070J LFS	7 ± 1.5			500,000
TLS A 100J LFS	10 ± 2			300,000
TLS A 040 T3J LFS	4 ± 0.8	30 ± 15	0.9 ± 0.3	1,000,000
TLS A 070 T3J LFS	7 ± 1.5			500,000
TLS A 100 T3J LFS	10 ± 2			300,000
TLS B 040J LFS	4+1.0/-0.5	50 ± 15	0.75 ± 0.2	1,000,000
TLS B 060J LFS	6+1.5/-0.75			500,000

PCB Layout

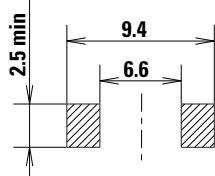

Circuit Diagram



TLS Drawings and Dimensions

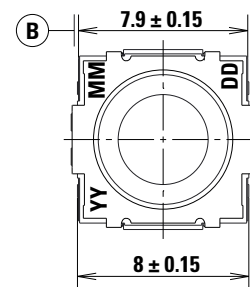
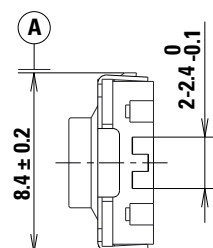
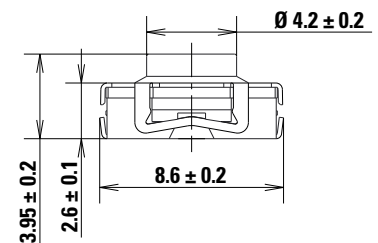

TLS Series

Soft Sound Tactile Switch



Ordering Number

Our easy build-a-switch concept allows you to mix and match options to create the switch you need. To order, select desired option from each category and place it in the appropriate box. For any part number different from those listed above, please consult your local representative.

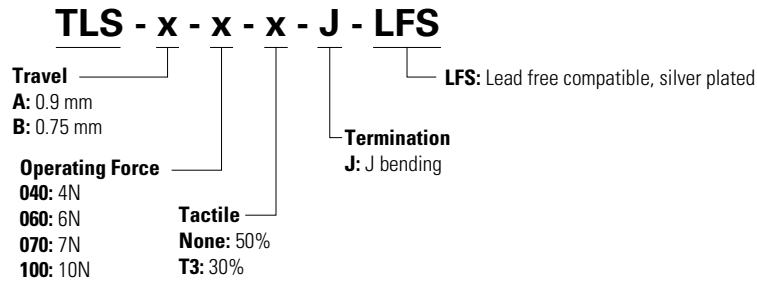

Disclaimer Notice - Information furnished is believed to be accurate and reliable. However, users should independently evaluate the suitability of and test each product selected for their own applications. Littelfuse products are not designed for, and may not be used in, all applications. Read complete Disclaimer Notice at <http://www.littelfuse.com/disclaimer-electronics>.